

BOOMER/WC CLUBROOM AUDIO SYSTEM

Application **Boomers wirelss mic**

<input type="checkbox"/>	Powerstrip	<input checked="" type="checkbox"/> On	<input type="checkbox"/> Off	
<input type="checkbox"/>	Upper Am	<input type="checkbox"/> On	<input checked="" type="checkbox"/> Off	
	Master volume	<input type="checkbox"/> Min	<input type="checkbox"/> Middle	<input type="checkbox"/> Max
<input type="checkbox"/>	Lower Amp	<input checked="" type="checkbox"/> On	<input type="checkbox"/> Off	
	Master volume	<input type="checkbox"/> Min	<input type="checkbox"/> Middle	<input type="checkbox"/> Max
<input type="checkbox"/>	Wall swtich by system	<input type="checkbox"/> SAT	<input checked="" type="checkbox"/> AV CAR	
	Volume setting	<input type="checkbox"/> Min	<input type="checkbox"/> Middle	<input type="checkbox"/> Max
<input type="checkbox"/>	HDMI remote	<input type="checkbox"/> On	<input checked="" type="checkbox"/> Off	
	#1 Apple TV			
	#2 TV2			
	#3 HIMI			
	#4			
	#5 DVD			
<input type="checkbox"/>	Northwest corner switch	<input checked="" type="checkbox"/> E COMB	<input type="checkbox"/> Normal	<input type="checkbox"/> W Comb
<input type="checkbox"/>	Kitchen wall switch	<input type="checkbox"/> Music	<input checked="" type="checkbox"/> Microphone	
	Volume side and ft rooms ad side ar rooms			
<input type="checkbox"/>	Projector remote	<input type="checkbox"/> On	<input type="checkbox"/> Off	
<input type="checkbox"/>	Women's wirelss	<input type="checkbox"/> On	<input type="checkbox"/> Off	
<input type="checkbox"/>	Boomer's box 1 wirelss	<input checked="" type="checkbox"/> On	<input type="checkbox"/> Off	H10 mic
<input type="checkbox"/>	Boomer's box 2 wirelss	<input type="checkbox"/> On	<input type="checkbox"/> Off	
<input type="checkbox"/>	Apple Remote	<input type="checkbox"/> On	<input type="checkbox"/> Off	
<input type="checkbox"/>	Shut down			

Boomers CLUB WIRELESS MICROPHONE SETUP

1. Wireless receiver and microphone are located in the Boomer cabinet by freezer.
2. Plug the wireless receiver into the outlet and the 3 prong (on bottom of plug) into either the electrical outlet/microphone plug a) below the screen or b) by the flag. Turn on the power on the wireless receiver box and on the microphone.
3. If two microphones are needed plug the 2nd wireless box into the other wall outlet.
4. One AC and microphone outlet is under the screen, the other is by the side wall near the flag. The other two wall outlets do not work.



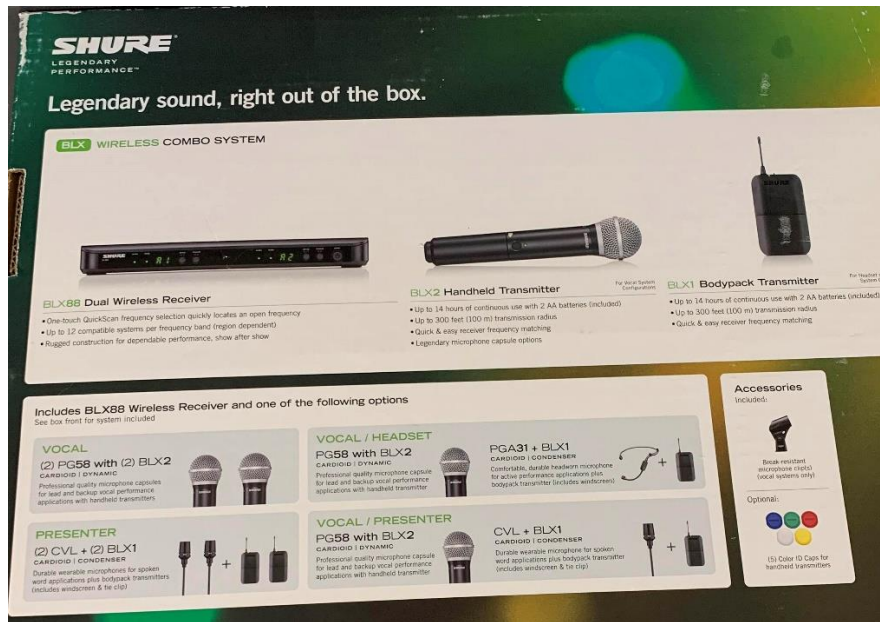

To remove plug, there is a release tab on the outlet where the cord plugs in.

5. In the Audio cabinet, West wall, Turn on the powerstrip at the bottom of the cabinet.
6. Turn on the lower amplifier.



7. Set the wall switch next to the audio cabinet to "AV" and the volume to the 12:00 setting.



8. If you hear a radio station, use the HDMI remote and press the OFF button.



9. Set the other wall switch (southwest corner) is set to E COMB



10. On the switch near the kitchen (west wall), set it to MICROPHONE



- ❑ WHEN FINISHED MAKE SURE TO TURN OFF THE LOWER AMPLIFIER AND POWER STRIP AND
- ❑ PUT AWAY THE WIRELESS RECEIVER BOX AND MICROPHONE.

TO CONTRL THE VOLUME

There are 4 different switches that control the volume. Here are the suggested settings.

Both wall switches, amp2(mic2), amp 2 Master volume

Suggested starting at

On the amplifier MIC2=3 o'clock position, MASTER = 3 o'clock



On the wall switch near the audio cabinet Volume = 12 o'clock (straight up)



The volume control for the front door area and side room is located by the kitchen wall,

